

REVISIONS			
DATE	NAME	NO.	REV.SHTS.
12-10-18	FRANK M. KRUPINSKI	37197	MM 12.01, 13.02, 14.02, 15.02, 21, 22, 23, 24, 27, 31, 32, 34, 01

THE AREAS, BOUNDARIES AND DIMENSIONS SHOWN ON THIS MAP ARE DERIVED FROM GROUND SURVEYS, AERIAL SURVEYS AND RECORDED PLANS, MAPS, DEEDS AND WILLS AND ARE TO BE USED FOR ASSESSMENT PURPOSES ONLY.

I HEREBY CERTIFY THAT THIS MAP HAS BEEN MADE UNDER MY IMMEDIATE SUPERVISION AND COMPLIES WITH THE LAWS OF THE STATE OF NEW JERSEY.

FRANK M. KRUPINSKI, N.J.P.L.S. Lic. No. 24GS03719700

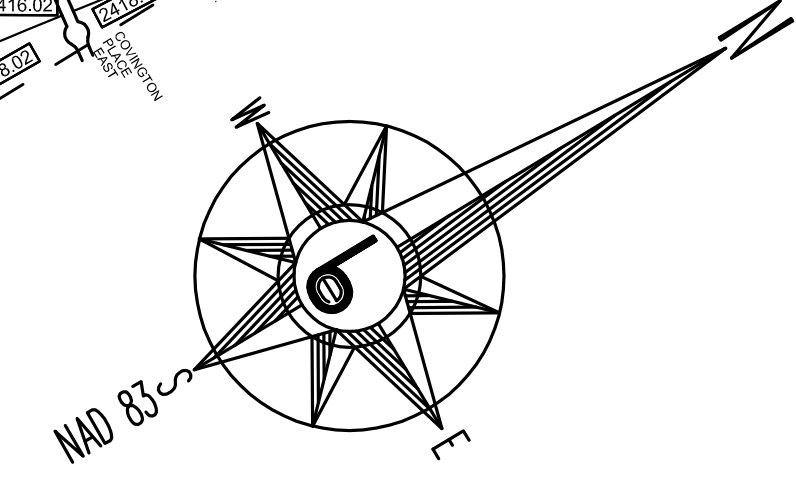

LEGEND

- 33 DETAIL SHEET NUMBER
- 5303 BLOCK NUMBER
- SHEET LIMIT
- BLOCK LIMIT
- 2310 BLOCK NUMBER (DETAIL)
- 5.01 LOT NUMBER (DETAIL)
- BLOCK LIMIT (DETAIL)

THIS TAX MAP SUPERCEDES THE TAX MAP APPROVED NOVEMBER 1, 1933.

TAX MAP

BOROUGH OF FRANKLIN LAKES

BERGEN COUNTY, NEW JERSEY
SCALE: 1"=800' OCTOBER 2016

FRANK M. KRUPINSKI, P.L.S.
BOSWELL McCLAVE ENGINEERING
330 PHILLIPS AVENUE
SOUTH HACKENSACK, N.J. 07606
TO SHOW CONDITIONS AS OF DEC. 31, 2018